

Don Kennedy and Sons House Moving Co. is the Tennessee Valley's oldest structural repair company, we are a third generation company. Our methods of structural repair are **specifically designed for the Tennessee Valley regions geographic**, we do not use a "bandwagon" method that was developed for a different geographic. In **twenty years** of structural repair, we have never had to go back on a foundation repair that we have made.

We use the most advanced state of the art hydraulic equipment and our methods utilize the most square footage of base in pier holes (an average of 6 sq. ft). Our piers offer **35 times** the support of our competition. Brick and mortar joints are color and textured matched to the home, so repaired areas are nearly impossible to notice afterwards.

We are a licensed and insured structural repair company, with below grade structural repair insurance, specific for this type of work, including liability and workmans compensation.

Our foundation repairs feature a lifetime transferable warranty.

Call us today and mention this ad to have a **FREE** structural inspection of your home's foundation by a "Trained Structural Support Technician".

**DON KENNEDY
AND SONS
HOUSE MOVING CO.**
HUNTSVILLE 533-1100 ALABAMA
**FOUNDATION REPAIR
SPECIALISTS**

**7201 Stringfield Road
P.O. Box 1287
Huntsville, AL 35807
Phone: 256.533.1100
Fax: 533.1191**

DonKennedyandSons.com

We accept all Major Credit Cards

**DON KENNEDY
AND SONS
HOUSE MOVING CO.**
**FOUNDATION REPAIR
SPECIALISTS**

"Advanced Technology backed by over 60 yrs Experience"



**The Tennessee Valley's
Oldest and Most
Experienced Foundation
Repair Specialists. Call us
today for a FREE
STRUCTURAL
INSPECTION OF YOUR
FOUNDATION.**



Our Pier Method vs. the Competition

- Our Piers are as wide as the footing and a solid column underneath.
- We excavate with a backhoe and visually inspect pier holes prior to concrete. Large rocks and debris are removed and holes are dug to suitable strata or bedrock.
- The “Stand Alone Pier™”. Each pier is self supporting.
- Our piers offer the most square footage of base. An average of 6 square feet.
- Their piers are segmented tapered rods, which are linked together.
- Piers are pushed into the ground, if large rock or debris is hit, piers can veer off on an angle. If angled piers will not reach suitable strata or bedrock, and can shift with time and need adjustment.
- Their piers rely on static pressure of the ground for support.
- Their piers are generally less than 4” at base and are tapered.

Imagine This

If you picture our piers as a concrete block and their piers as a pencil, which do you think you be easier to push into the ground with the palm of your hand? Which would offer you more support and stability? Which pier do you think will shift over time?

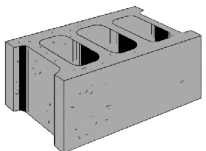

Warning Signs of Foundation Problems



What To Look For

- Sheetrock cracks over doors
- Stress cracks in brick veneer
- Bricks separating from framing
- Interior floors sagging
- Interior doors won't close properly

WATERPROOFING

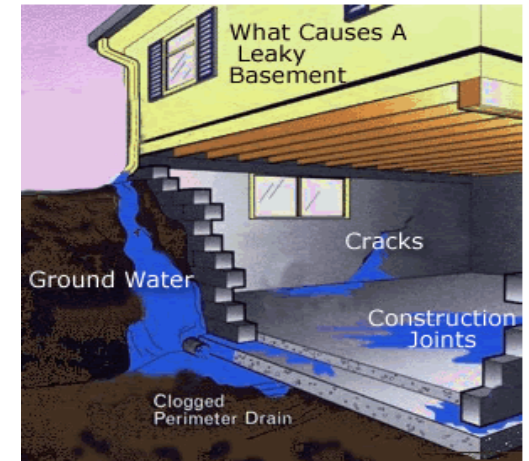

All across the Tennessee Valley, waterproofing is a major concern. Water problems can cause foundation settlement, mold, mildew, and multiple other problems to your home. Because every foundation water problem is unique, Don Kennedy and Sons will offer a customized solution to fit your home's needs. Leave all your below grade waterproofing to us.